

Biodiversity Offset Scheme (BOS) Entry Threshold Map

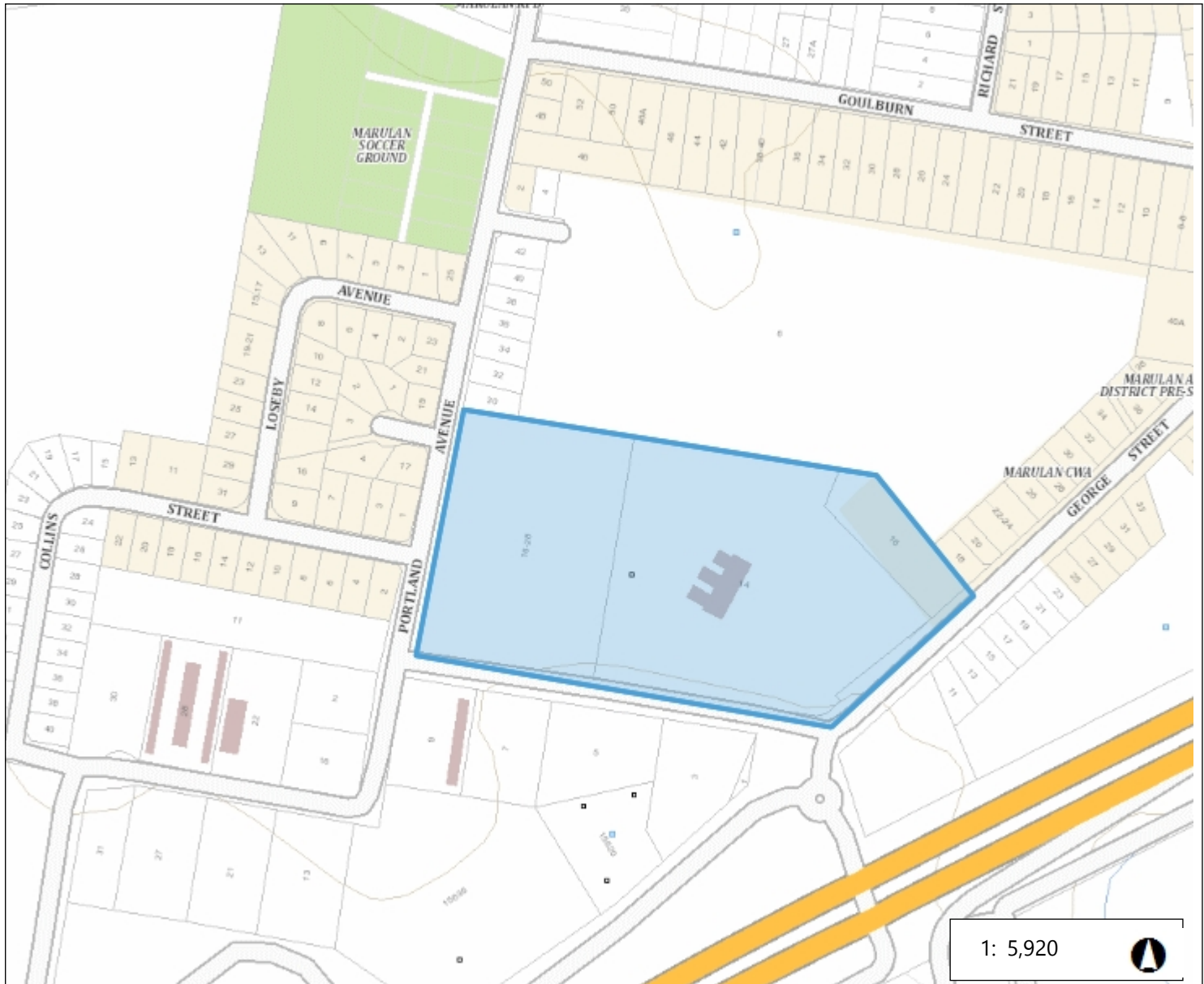

1: 5,920



300.7 0 150.37 300.7 Metres

WGS\_1984\_Web\_Mercator\_Auxiliary\_Sphere

This map is a user generated static output from an Internet mapping site and is for reference only. Data layers that appear on this map may or may not be accurate, current, or otherwise reliable.

THIS MAP IS NOT TO BE USED FOR NAVIGATION

Legend

- Biodiversity Values that have been mapped for more than 90 days
- Biodiversity Values added within last 90 days

Notes

© Office of Environment and Heritage |  
NSW Environment & Heritage

## Biodiversity Values Map and Threshold Report

### Results Summary

<b>Date of Calculation</b>	27/04/2021 3:13 PM	<b>BDAR Required*</b>
<b>Total Digitised Area</b>	7.6 ha	
<b>Minimum Lot Size Method</b>	Lot size	
<b>Minimum Lot Size</b>	0 ha	
<b>Area Clearing Threshold</b>	0.25 ha	
<b>Area clearing trigger</b> Area of native vegetation cleared	Unknown #	Unknown #
<b>Biodiversity values map trigger</b> Impact on biodiversity values map(not including values added within the last 90 days)?	no	no
<b>Date of the 90 day Expiry</b>	N/A	

\*If BDAR required has:

- at least one 'Yes': you have exceeded the BOS threshold. You are now required to submit a Biodiversity Development Assessment Report with your development application. Go to <https://customer.lmbc.nsw.gov.au/assessment/AccreditedAssessor> to access a list of assessors who are accredited to apply the Biodiversity Assessment Method and write a Biodiversity Development Assessment Report
- 'No': you have not exceeded the BOS threshold. You may still require a permit from local council. Review the development control plan and consult with council. You may still be required to assess whether the development is "likely to significantly affect threatened species' as determined under the test in s. 7.3 of the Biodiversity Conservation Act 2016. You may still be required to review the area where no vegetation mapping is available.

# Where the area of impact occurs on land with no vegetation mapping available, the tool cannot determine the area of native vegetation cleared and if this exceeds the Area Threshold. You will need to work out the area of native vegetation cleared - refer to the BOSET user guide for how to do this.

On and after the 90 day expiry date a BDAR will be required.

## Disclaimer

This results summary and map can be used as guidance material only. This results summary and map is not guaranteed to be free from error or omission. The State of NSW and Office of Environment and Heritage and its employees disclaim liability for any act done on the information in the results summary or map and any consequences of such acts or omissions. It remains the responsibility of the proponent to ensure that their development application complies with all aspects of the *Biodiversity Conservation Act 2016*.

The mapping provided in this tool has been done with the best available mapping and knowledge of species habitat requirements. This map is valid for a period of 30 days from the date of calculation (above).

## Acknowledgement

I as the applicant for this development, submit that I have correctly depicted the area that will be impacted or likely to be impacted as a result of the proposed development.

Signature \_\_\_\_\_ Date: 27/04/2021 03:13 PM